

*Step 1:*

Fold the bow tail over on the embossed crease line, at an angle.

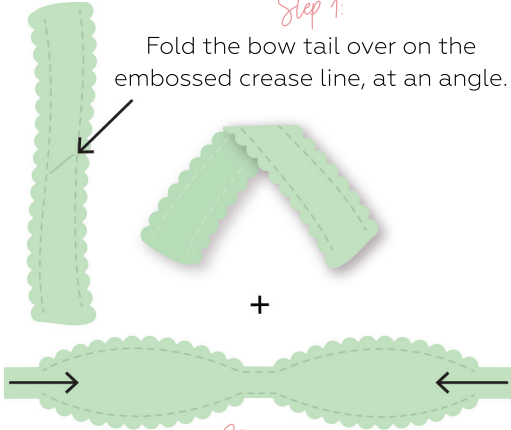

*Step 2:*

Curl the end tabs of the bow towards its center and overlap.

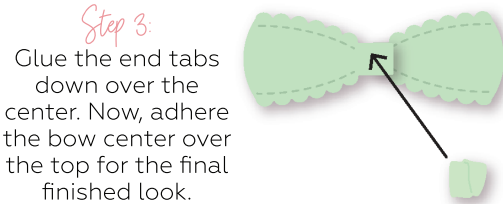

*Step 3:*

Glue the end tabs down over the center. Now, adhere the bow center over the top for the final finished look.

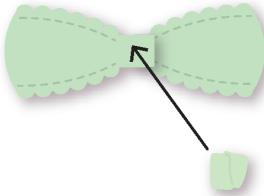

*Use multiple bows for layered effects!*

Try popping layers up with foam for even more dimension!



*Scalloped*  
Bow Pieces

*Classic*  
Bow Pieces

*Decorate your card...  
envelope, gift card  
holder and more!*



*For more information, visit our website*

or any of our social media channels! Search for Honey Bee Stamps  
on Instagram, Facebook, Pinterest, YouTube and TikTok! #HoneyBeeStamps